

TELONG ENERGY TECHNOLOGY CO., LTD.

Anjia Industrial Zone, HuanGuan South Road, GuanLan Town, ShenZhen City, GuangDong Province, China

TEL:+86-755-29052355 FAX:+86-755-27981742 E-mail: telongbattery@sztlg.com <http://www.sztlg.com>

ER32100 Lithium Thionyl Chloride Battery

TECHNICAL DATA

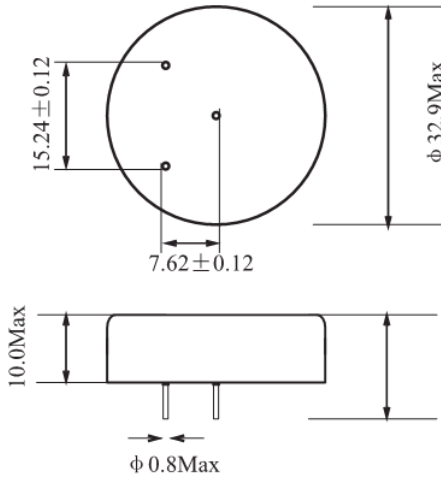

Characteristics: ($23 \pm 2^\circ\text{C}$)

Nominal capacity (1.3mA-2.0V)1.7AH

Nominal voltage3.6V

Max. constant current of discharge..... 10mA

Max. discharge current(pulse).....20mA

Weight.....22g

Volume.....As diagram

Operating temperature range..... $-55^\circ\text{C} \sim +85^\circ\text{C}$

TECHNICAL CHARACTERISTICS

Discharge characteristics at $23 \pm 2^\circ\text{C}$

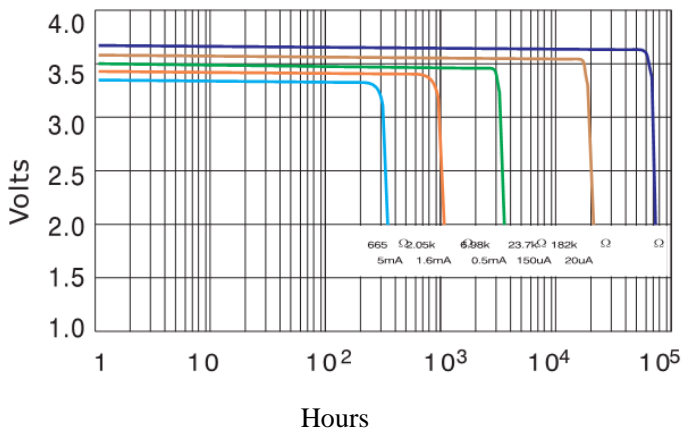

Capacity VS. Current

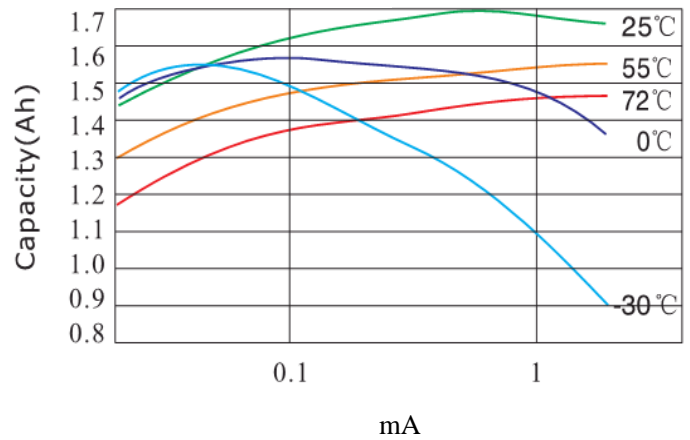

Voltage VS. Temperature

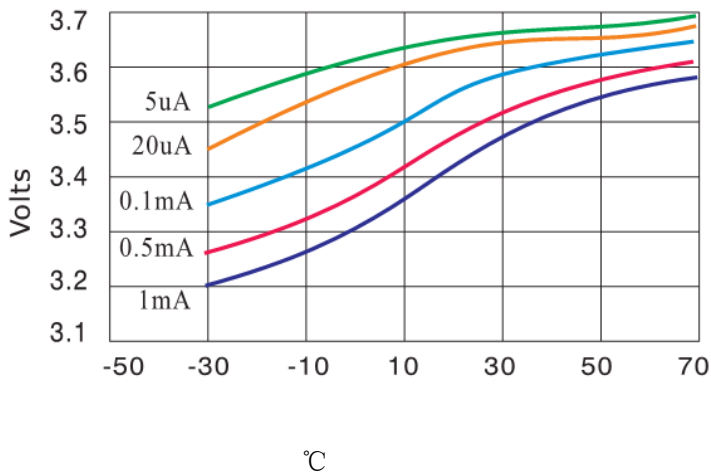

Important Notes:

Do not short or charge the battery.
Over-discharging, crushing, incinerating, and disassembling the battery are prohibited.
Do not heat/use the battery beyond the permitted temperature range.